

Aspirante Remote

remote electric shower

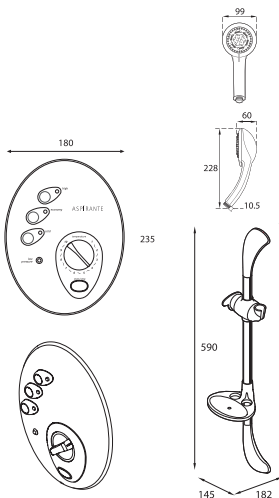

Temperature Control	Stabilised
Power Ratings	8.5kW, 9.5 kW, 10.5 kW
Inlet Connection	15mm compression
Water Entry Points	Bottom, back (right hand side unit)
Cable Entry Points	Back, top (right hand side unit)
Outlet Connection	1/2" BSP
Plumbing System	Cold water only
Minimum Running Pressure/Flow	1 Bar @ 8 l/min and 1.5 Bar @ 11l/min for 10.5 kW
Maximum Static Pressure	10 Bar
Surface Mounted Only	
Approvals	BEAB, CE, BKM
Guarantee	2 years

Operating Features

- Low voltage wired technology
- Discrete control panel that operates up to 3.5m away from power pack
- Through the wall bulkhead and riser rail
- Push button start/stop with phased shutdown
- Push button power selector for cold/economy/high
- Temperature control with numbered dial
- Low pressure indicator
- Rub clean showerhead
– 5 spray patterns

Finish	Power	Code
Chrome	8.5 kW	ASP3008SI
Chrome	9.5 kW	ASP3009SI
Chrome	10.5 kW	ASP3001SI